

| Ausgabe Issue | | Bild Nr Picture No | | VARIOLUX 45 EC | | VARIOLUX 45 EC | | Seite Page | |
|------------------|-----------------|-----------------------|--|------------------------|------------------------------|-----------------------------|-------------|--------------------|--|
| 2002- 2 | | B058 | | | | | | 22 | |
| Pos. Fig. | Anzahl/Quantity | | | Artikel Nr. Part No | Bezeichnung | Description | Satz Kit | Anmerkung Notes | |
| | 794 537 | 794 538 | | | | | | | |
| X | 1 | 1 | | 1117-3356-02 | Chassie..... | Deck..... | | | |
| | 2 | 1 | | 1117-3258-01 | Verstärkerungsstrebe | Reinforcement..... | | | |
| | 3 | 2 | | 1111-3164-01 | Radbolzen..... | Wheel axle bolt..... | | | |
| | 4 | 1 | | 1117-1173-01 | Hinterachse | Shaft- backside..... | | | |
| | 5 | 2 | | 9595-0212-00 | Spannstift | Locating pin | | | |
| | 6 | 2 | | 1117-3256-01 | Raddeckel | Wheel protection cap | | | |
| | 7 | 1 | | 1117-1174-01 | Höheneinstellhebe | Height adjust lever | | | |
| | 8 | 2 | | 1111-3238-01 | Rad..... | Wheel..... | | | |
| | 9 | 2 | | 9699-0078-02 | Scheibe..... | Washer..... | | | |
| | 10 | 1 | | 1117-3008-01 | Leitschiene- hintere | Baffle- rear | | | |
| | 11 | 12 | | 9836-9516-12 | Schraube | Screw..... | | | |
| X | 12 | 1 | | 1117-1156-11 | Klappe- rot..... | Rear flap- red | | | |
| | 13 | 1 | | 1117-1143-01 | Achse..... | Shaft | | | |
| X | 14 | 1 | | 1117-1126-01 | Feder | Spring- rear flap | | | |
| X | 15 | 1 | | 1117-3351-02 | Motordeckel..... | Motor cover | | | |
| | 16 | 1 | | 1117-3007-01 | Leitschiene- vordere | Baffle- front | | | |
| | 17 | 1 | | 1117-1334-01 | Vorderachse | Front shaft..... | | | |
| | 18 | 2 | | 1117-1161-01 | Radschutz..... | Wheel protection | | | |
| | 19 | 2 | | 1111-3163-01 | Rad..... | Wheel..... | | | |
| | 20 | 2 | | 1111-3084-07 | Nabenkapsel- grau..... | Hub cap- grey..... | | | |
| | 21 | 2 | | 1111-3085-07 | Nabenkapsel- grau..... | Hub cap- grey..... | | | |
| | 22 | 1 | | 1117-1130-01 | Höheneinstellstange | Connection rod | | | |
| | 23 | 8 | | 1117-1131-01 | Mutter | Nut | | | |
| | 24 | 2 | | 9865-0816-16 | Schraube | Screw..... | | | |
| | 25 | 6 | | 9699-0028-02 | Scheibe..... | Flat washer..... | | | |
| | 26 | 2 | | 9898-0845-12 | Schraube | Screw..... | | | |
| | 27 | 1 | | 9400-0224-00 | Kondensator | Capacitor | | | |
| | 28 | 4 | | 9579-0008-00 | Kabelhalter..... | Cable holder | | | |
| | 29 | 4 | | 1117-3194-01 | Verriegelungsrad | Locking knob | | | |
| | 30 | 7 | | 9799-0831-02 | Mutter | Nut | | | |
| | 31 | 1 | | 1117-3141-01 | Führungsholm- Unterteil..... | Handle- lower part..... | | | |
| | 32 | 1 | | 1117-3043-01 | Führungsholm- Obert..... | Handlebar- upper part | | Inkl. 71, 72 | |
| X | 33 | 1 | | 1117-8283-01 | Schutz | Guard | | | |
| | 34 | 1 | | 1117-1135-02 | Deckel- schwarz..... | Cover- black | | | |
| X | 35 | 1 | | 1117-3365-01 | El. Motor..... | El. motor | | Inkl. 27 | |
| X | 36 | 1 | | 1117-1157-11 | Behälterdeckel- rot..... | Grassbag cover- red | | Inkl. 34 | |
| | 37 | 1 | | 1117-1218-01 | Behälter- Unterteil..... | Lower grass bag | | | |
| | 38 | 4 | | 9997-0820-16 | Schraube | Screw..... | | | |
| | 39 | 10 | | 9678-0009-02 | Schloßscheibe | Lock washer..... | | | |
| | 40 | 4 | | 9716-0831-02 | Mutter | Nut | | | |
| X | 41 | 1 | | 1117-3352-02 | Motordeckel..... | Motor cover | | | |
| | 42 | 1 | | 1117-1151-01 | Messerhalter..... | Blade mount..... | | | |
| X | 43 | 1 | | 1111-9724-01 | Messer..... | Blade..... | | | |
| X | 44 | 1 | | 1117-3081-01 | Motordeckel..... | Motor cover | | | |
| | 45 | 1 | | 1117-1111-01 | Messerscheibe..... | Disc washer | | | |
| | 46 | 1 | | 1111-9715-01 | Messerbolzen | Blade bolt..... | | | |
| | 47 | 2 | | 9997-0614-16 | Schraube | Screw..... | | | |
| | 48 | 2 | | 1117-1175-01 | Scheibe..... | Washer..... | | | |
| | 49 | 6 | | 1117-1252-01 | Schraube | Screw..... | | | |
| | 50 | 7 | | 9699-0062-02 | Scheibe..... | Flat washer..... | | | |
| | 51 | 3 | | 9997-0830-16 | Schraube | Screw..... | | | |
| | 52 | 2 | | 9699-0036-02 | Scheibe..... | Flat washer..... | | | |
| | 53 | 5 | | 9836-9512-12 | Schraube | Screw..... | | | |
| | 54 | 2 | | 1117-1192-01 | Isolierplatte..... | Isolation | | | |
| | 55 | 2 | | 1117-1267-01 | Bolzen..... | Bolt | | | |
| | 56 | 4 | | 9694-0003-00 | Scheibe..... | Washer..... | | | |
| | 57 | 1 | | 1117-1299-01 | Ventilator | Impeller..... | | | |
| | 58 | 8 | | 9549-0053-00 | Kugellager | Ball bearing | | | |
| | 59 | 2 | | 9898-0835-12 | Schraube | Screw..... | | | |
| | 60 | 4 | | 1117-1364-01 | Schraube | Screw..... | | | |
| | 61 | 1 | | 1117-3028-01 | Montagesatz | Assy kit | | | |
| | 62 | 1 | | 1117-1119-01 | Propfen..... | Cap..... | | | |
| | 63 | 1 | | 1117-1148-01 | Deckel..... | Cap..... | | | |

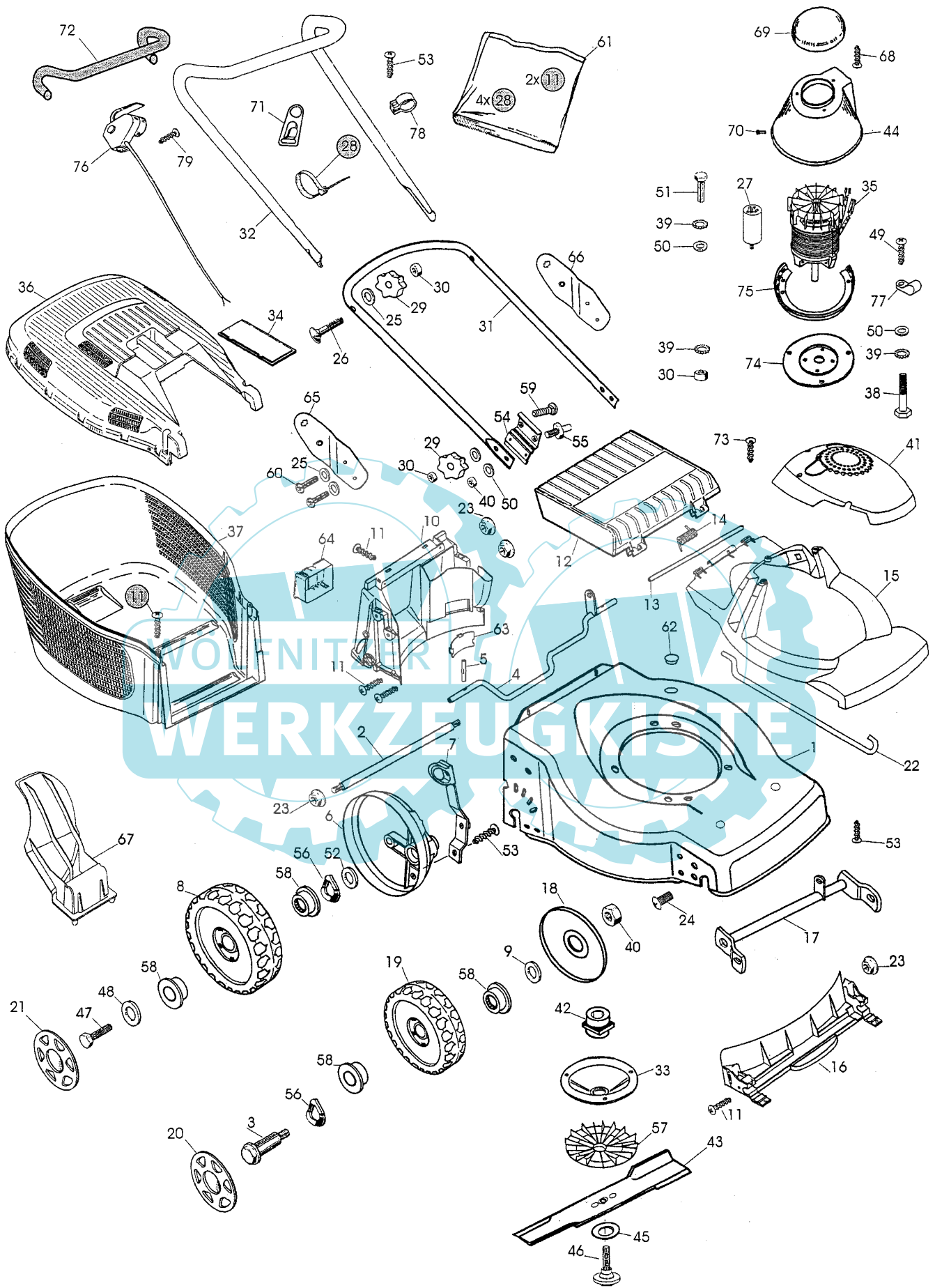

B058



| Ausgabe Issue | | Bild Nr Picture No | | VARIOLUX 45 EC | VARIOLUX 45 EC | Seite Page | | |
|------------------|-----------------|-----------------------|---|------------------------|-------------------------|--------------------------|-------------|--------------------|
| 2002- 2 | | B058 | | | | 24 | | |
| Pos. Fig. | Anzahl/Quantity | | | Artikel Nr. Part No | Bezeichnung | Description | Satz Kit | Anmerkung Notes |
| | 794 537 | 794 538 | | | | | | |
| | 64 | 1 | 1 | 1111-2927-01 | Batteriehalter | Battery holder | | |
| | 65 | 1 | 1 | 1117-1310-01 | Halter- rechts | Handle support- R.H..... | | |
| | 66 | 1 | 1 | 1117-1309-01 | Halter- links | Handle support- L.H..... | | |
| | 67 | 1 | 1 | 1117-3001-01 | Mulcherpropfen | Mulch plug..... | | |
| X | 68 | 3 | 3 | 1117-1102-01 | Schraube | Screw..... | | |
| X | 69 | 1 | 1 | 1117-3082-01 | Deckel..... | Cap..... | | |
| X | 70 | 3 | 3 | 1117-3074-01 | Clip | Clip..... | | |
| | 71 | 1 | 1 | 9579-0009-00 | • Kabelhalter | • Cable restrainer | | |
| | 72 | 1 | 1 | 1117-3036-01 | • Griff | • Foam grip..... | | |
| | 73 | 3 | 3 | 9836-9525-12 | Schraube | Screw..... | | |
| X | 74 | 1 | 1 | 1117-3080-01 | Motorflansch | Motor flange | | |
| X | 75 | 1 | 1 | 1117-3079-02 | Unterteil- Deckel | Lower part- cover | | |
| | 76 | 1 | | 1117-1123-01 | Schalter | Switch | | |
| | 76 | | 1 | 1117-3270-01 | Schalter | Switch | | die Schweiz |
| | 77 | 1 | 1 | 1117-1245-01 | Kabelklemme | Cable clamp | | |
| | 78 | 1 | 1 | 1117-3048-01 | Spannbügel | Clip..... | | |
| | 79 | 2 | 2 | 9836-9225-12 | Schraube | Screw..... | | |

